



# McDonald County Commission

*Bill Lant, Presiding Commissioner*

417-223-7516

**Kimberly Bell, County Clerk**

**PO Box 665, Pineville, MO 64856**

417-223-7530 Fax 417-223-7519

[mcdonald@sos.mo.gov](mailto:mcdonald@sos.mo.gov)

[commission@olemac.net](mailto:commission@olemac.net)

---

**Jamey Cope**  
Eastern Commissioner

**Rick Lett**  
Western Commissioner

## WATER PARTS FOR WATER AND SEWER MCDONALD COUNTY HEALTH DEPARTMENT

- 1 - Tapping sleeve 8" x 8"
- 1 - Flange XMJ Gate Valve
- 1 - 45-degree bend
- 2 - MJ Gate Valve 8"
- 1 - 8" Tee
- 1 - 8" Plug
- 1 - 8" x 6" Reducer
- 1 - 6" Gate Valve
- 1 - 6" Anchor Coupling
- 1 - 4' bury Mueller Fire Hydrant
- 4 - Valve Box's 36" bury
- 1 - 8" x 2" hinged Brass Saddle
- 1 - 2" Corp Stop
- 1 - 2" Meter Setter
- 8 - C-900 Mega Lugs with Bolts 8"
- 5 - Bolt packs 8"



SUBJECT	PREPARED BY
	DATE
	SHEET OF

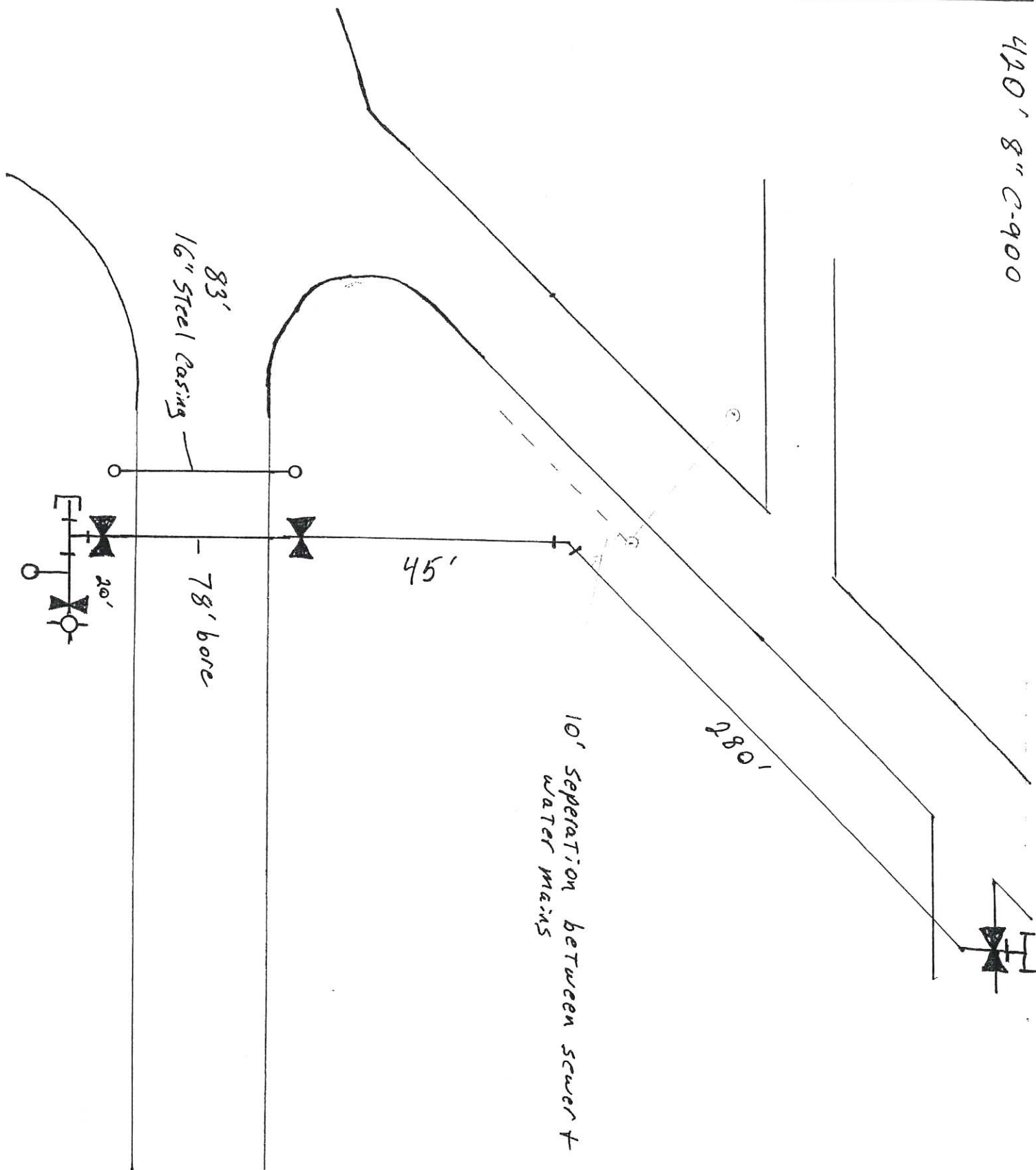

420' 8" C-900

Existing 8" water



SUBJECT	PREPARED BY
	DATE
	SHEET OF

- 392'-8" SDR 26
- 3/4" bedding 4 loads
- 1/4" STREET cur 2 loads
- 4 - New manholes
- 4 - SS. 4" SPACERS
- 1 - End seals

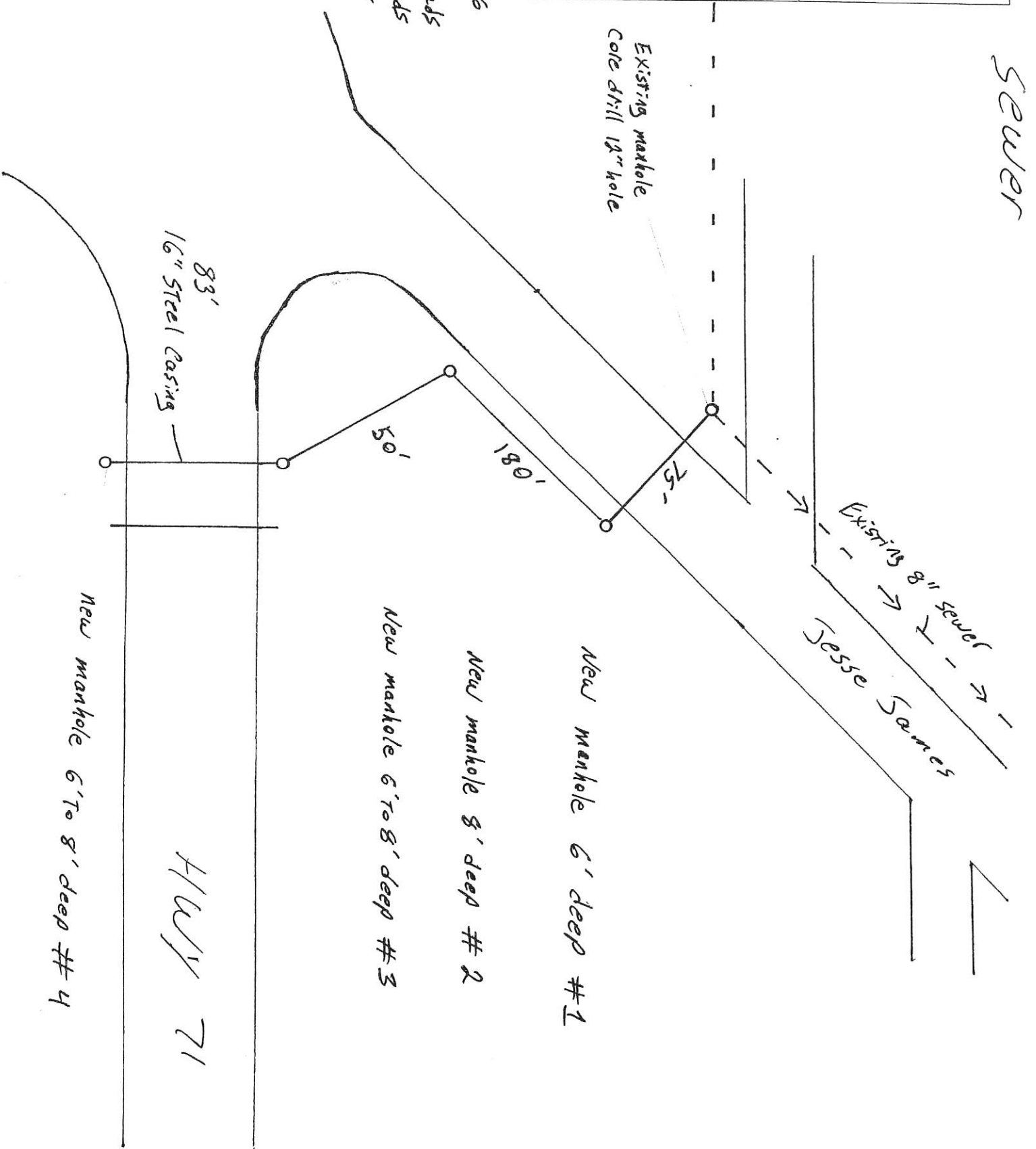

TRI-STATE ENGINEERING, INC.

702 S. Main • Joplin, MO 64801 • 417-781-0643 • tristate-engineering.com